

Consultants:
 H.F. LENZ COMPANY Civil / MEP /
 KILLER ENGINEERS Structural
 BARRY J. HAUGH Food Service Equipment

Owner's Consultants:

Seal:

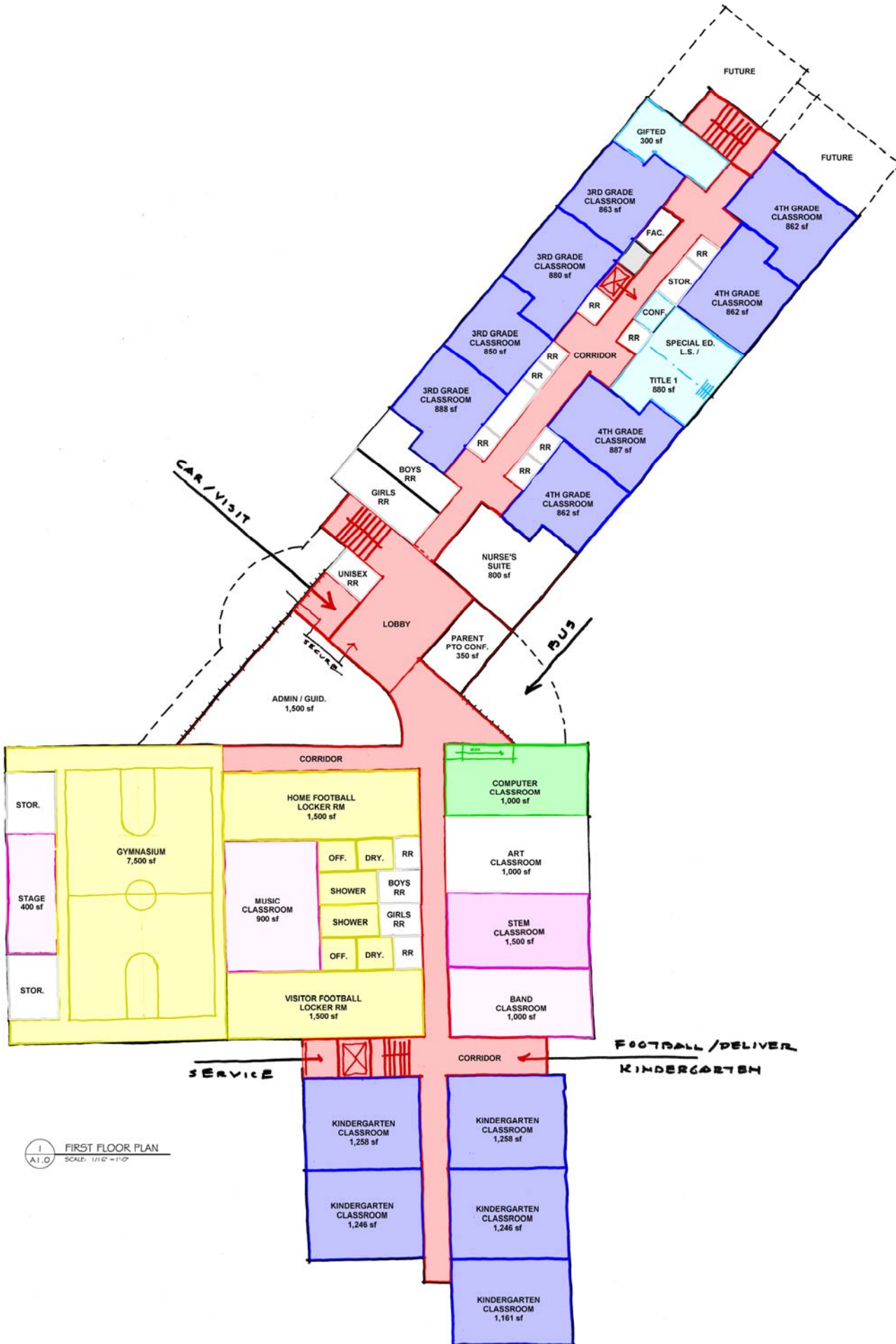

1 FIRST FLOOR PLAN
 A1.0 SCALE: 1/16" = 1'-0"

NORTH

ISSUE LOG

Distribution	Date	No.

Client:
 WESTMONT HILLTOP
 SCHOOL DISTRICT

**NEW WESTMONT
 ELEMENTARY SCHOOL**

Drawing Title:
FIRST FLOOR PLAN

**DESIGN DEVELOPMENT
 PLANCON B REVIEW**

First Issue Date:
 JUNE 30, 2015
 Project No.: 2015-10
 Drawing No.:

Consultants:
 H.F. LENZ COMPANY
 KELLER ENGINEERS
 BARRY J. HAUGH

Civil / MEPFP
 Structural
 Food Service Equipment

Owner's Consultants:

Seal:

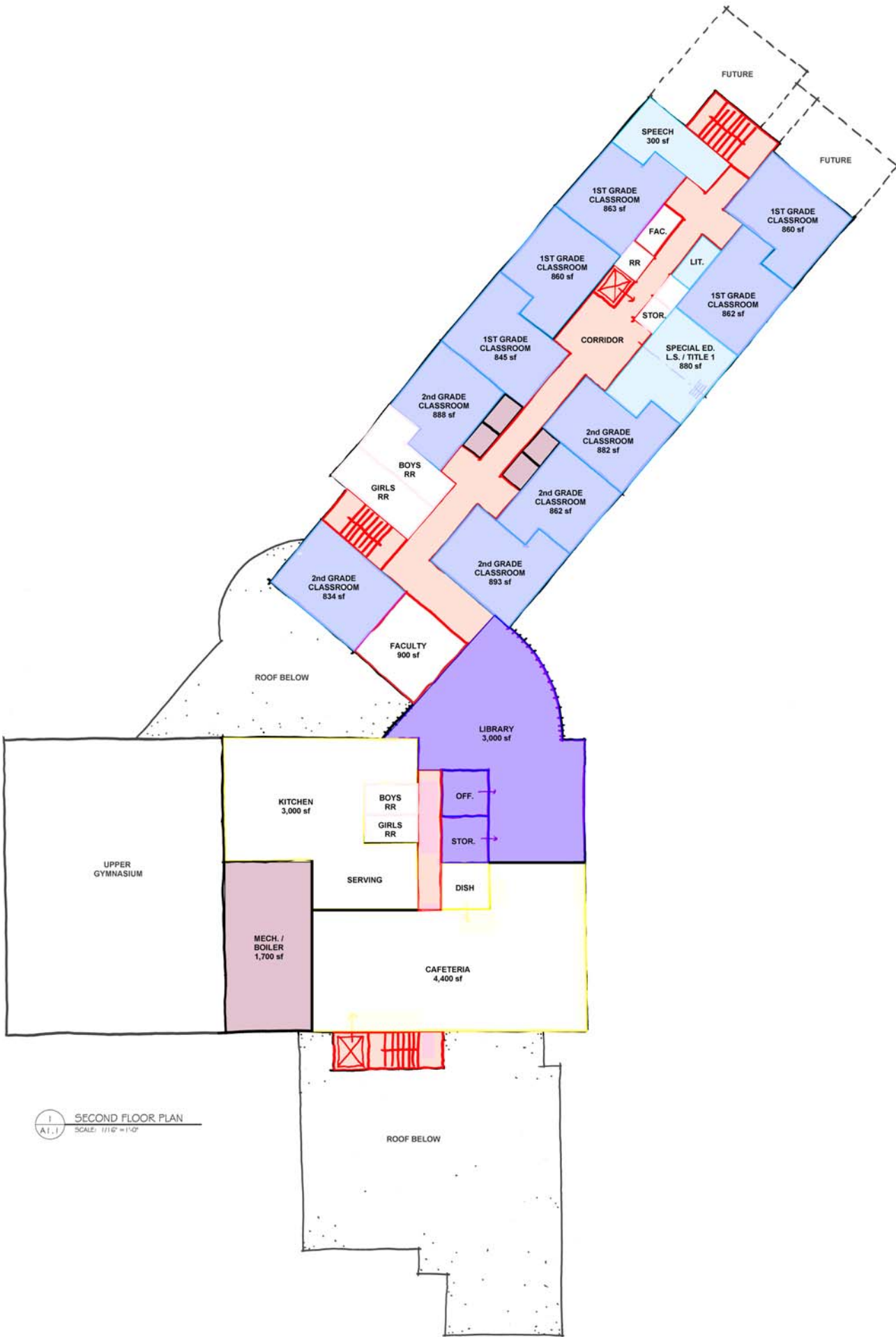

1 SECOND FLOOR PLAN
 A1.1 SCALE: 1/16" = 1'-0"



ISSUE LOG

Distribution	Date	No.

Client:
 WESTMONT HILLTOP
 SCHOOL DISTRICT

**NEW WESTMONT
 ELEMENTARY SCHOOL**

Drawing Title:
SECOND FLOOR PLAN

DESIGN DEVELOPMENT
 PLANCON B REVIEW

First Issue Date:
 JUNE 30, 2015

Project No.:
 2015-10

Drawn by:

Drawing No.:

Consultants:
 H.F. LENZ COMPANY Civil/MPEEP
 KELLER ENGINEERS Structural
 BARRY J. HAUGH Food Service Equipment

Owner's Consultants:

Seal:

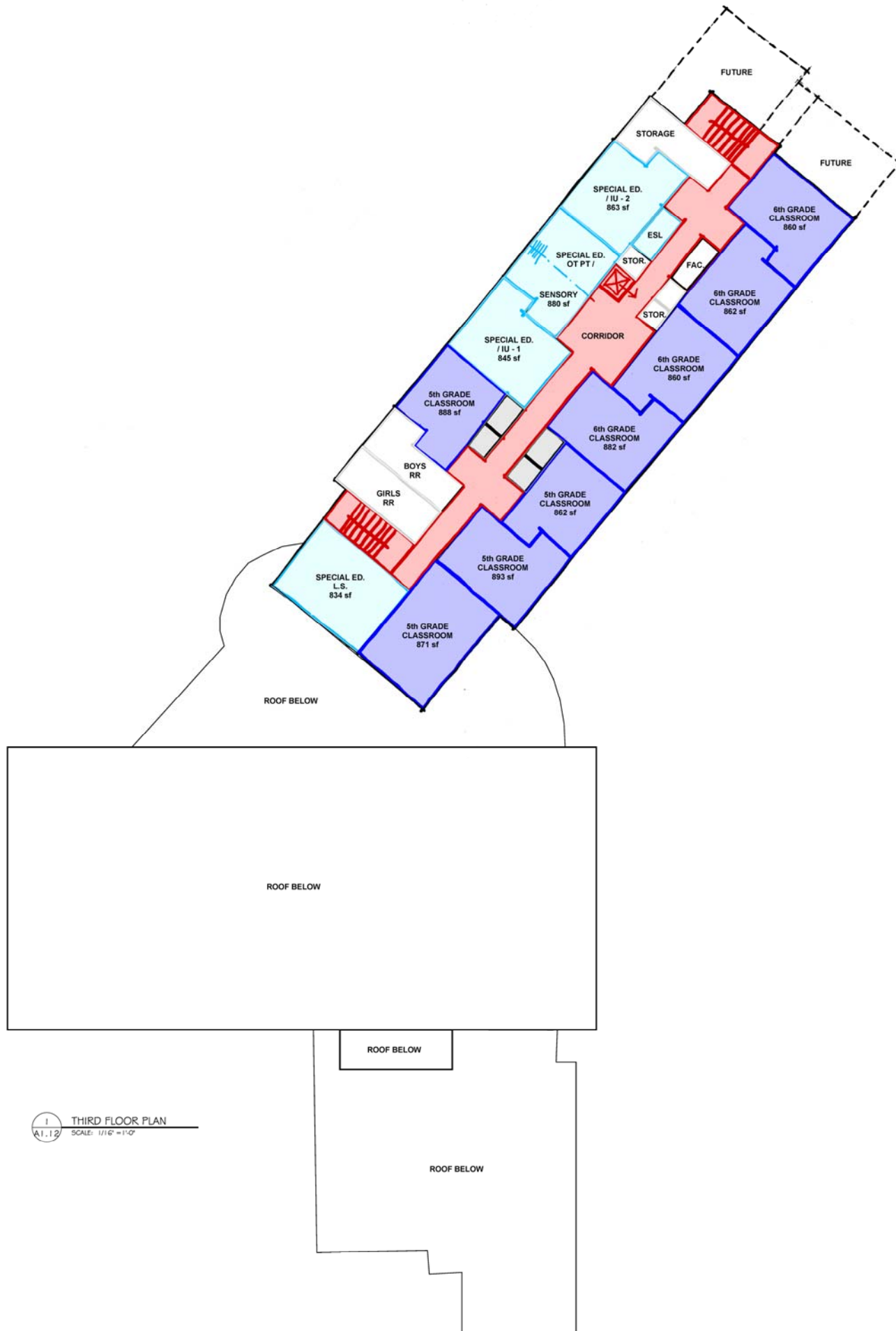

ISSUE LOG

Distribution	Date	No.

Client:
 WESTMONT HILLTOP
 SCHOOL DISTRICT

**NEW WESTMONT
 ELEMENTARY SCHOOL**

Drawing Title:
THIRD FLOOR PLAN

**DESIGN DEVELOPMENT
 PLANCON B REVIEW**

First Issue Date:
JUNE 30, 2015
 Project No.: **2015-10**
 Drawing No.:

1 THIRD FLOOR PLAN
 SCALE: 1/16" = 1'-0"